

**Pin Group** - Heat treated alloy pins and super hard alloy bushings.

**Mounting Eyes** - Dedicated to your machine at the time of construction.

**Single Anvil** - QT100 hardened Alloy Steel. Virtually unbreakable.

**Side Plates** - Extra thick QT100 Alloy Steel. Serrated edges for grip and control.

**Grubbing Teeth** - Welded AR400 teeth for ripping, prying and digging.

**Splitter Fang** - Welded AR400, optimal geometry for efficient splitting with and across the grain.

**Knife Blade** - Solid AR400 welded blade with full convex profile.

**Brace/Cylinder** - Extra strong three position mechanical brace OR optional high pressure cylinder.

**Torque Tube** - Massive steel torque tube eliminates blade twist.

**Brace Mount** - Oversize pin to receive high pressure cylinder or rigid brace.

**Rhino Horn** - Rip, Flip and Back Drag.

**Main Blade** - Extra thick QT100 Alloy Steel.

## Features & Benefits

- Heavy duty hydraulic brace articulates cutting blade and fang for maximum versatility.
- Power action geometry yields unsurpassed splitting force, both radially and axially.
- Wide Opening allows a clean purchase from any angle.

## Cross Cutting



## Solid Blade Design



## QAU Compatible



## AXE Series Typical Specifications

Carrier	Model	Tip Radius mm [in]	Weight kg [lb]
13 - 17 t	AXE150	824 [32]	527 [1,160]
16 - 24 t	AXE200	919 [36]	742 [1,633]
22 - 28 t	AXE250	1,066 [42]	1,179 [2,594]
25 - 38 t	AXE350	1,141 [45]	1,378 [3,032]
35 - 50 t	AXE450	1,428 [56]	2,253 [4,957]

[nye.ca/axe](http://nye.ca/axe)



All Nye products are warranted to be free of defects in materials and workmanship for a period of 2 years or 2,000 hours.

Specifications subject to change.

[nye.ca/terms](http://nye.ca/terms)

## The New AXE Stump Harvester :

The Nye AXE heavy duty stump harvester is our price point alternative to the premium SHX model. The AXE features welded AR400 teeth and a straight knife for stump processing where equipment cost is a deciding factor.

The replaceable AR400 teeth and piercing tip are welded-in solid, so they cannot fall out and damage grinders and other downstream processing equipment. Simple maintenance by welding and hard-facing keeps the points sharp and ready for action. The AXE harvester has no pinned in teeth or regular replacement parts to buy.

Simplified blade geometry – The AXE harvester has a single, welded-in AR400 blade with the same CNC sculpted full-convex edge as used on our premium SHX compound blade harvesters. You get the same heavy duty blade technology in a slightly less aggressive, less expensive yet easier to maintain harvester. A single AR400 anvil provides a solid striking surface for the blade, making quick work cross cutting logs and roots.

Nye stump harvesters are easy to install, safe, silent to operate and available in Quick Coupler and Pin Grabber compatible versions.

AXE - The best there is, from the King of Heavy Duty!

**Nye Manufacturing Ltd.**  
3585 Mavis Rd.  
Mississauga, ON L5C 1T7  
Canada  
+1 905 897 2311  
[sales@nye.ca](mailto:sales@nye.ca) [nye.ca](http://nye.ca)

**National Attachments, Inc.**  
29 Olde Canal Way  
Gorham, ME 04038  
(800) 839 9981  
[sales@nationalattachments.com](mailto:sales@nationalattachments.com)



Scan for videos →



CARRIER [x1000lbs]	MODEL*	TOOTH*	WEIGHT	TIP RADIUS (A)	WIDTH (B)	LENGTH (C)	THICKNESS (D)	OPENING (E)
13 - 17 t [29 - 37]	AXE150	2 1/2"	527 [1,160]	824 [32]	420 [16.5]	410 [16]	2 1/2"	1,188 [47]
	AXE150Q		650 [1,430]	875 [34]	440 [17]	556 [22]		1,213 [48]
	AXE150U		725 [1,450]	875 [34]	440 [17]	556 [22]		1,213 [48]
16 - 24 t [35 - 53]	AXE200	2 1/2"	742 [1,633]	919 [36]	452 [18]	615 [24]	2 1/2"	1,261 [50]
	AXE200Q		865 [1,903]	945 [37]	482 [19]	655 [26]		1,448 [57]
	AXE200U		1,002 [2,205]	1,051 [41]	520 [20.5]	675 [27]		1,677 [66]
22 - 28 t [48 - 62]	AXE250	3"	1,179 [2,594]	1,066 [42]	540 [21]	788 [31]	3"	1,690 [67]
	AXE250Q		1,206 [2,653]	1,103 [43]	550 [22]	790 [31]		1,730 [68]
	AXE250U		1,245 [2,739]	1,125 [44]	565 [22]	790 [31]		1,765 [69]
26 - 38 t [57 - 84]	AXE350	3"	1,378 [3,032]	1,141 [45]	574 [22.5]	793 [31]	3"	1,782 [70]
	AXE350Q		1,548 [3,406]	1,275 [50]	605 [23]	800 [31]		1,956 [77]
	AXE350U		1,911 [4,205]	1,330 [52]	621 [24]	800 [31]		2,269 [89]
35 - 50 t [77 - 110]	AXE450	3 1/2"	2,253 [4,957]	1,428 [56]	655 [26]	825 [32]	3 1/2"	2,275 [90]
	AXE450Q		2,650 [5,830]	1,523 [60]	715 [28]	868 [34]		2,450 [96]
	AXE450U		3,200 [7,040]	1,650 [65]	715 [28]	893 [35]		2,793 [110]

\* Q = Quick Coupler, U = QAU compatible \* Customer's choice Specifications subject to change Units of Measure: kg [lb] and mm [in]

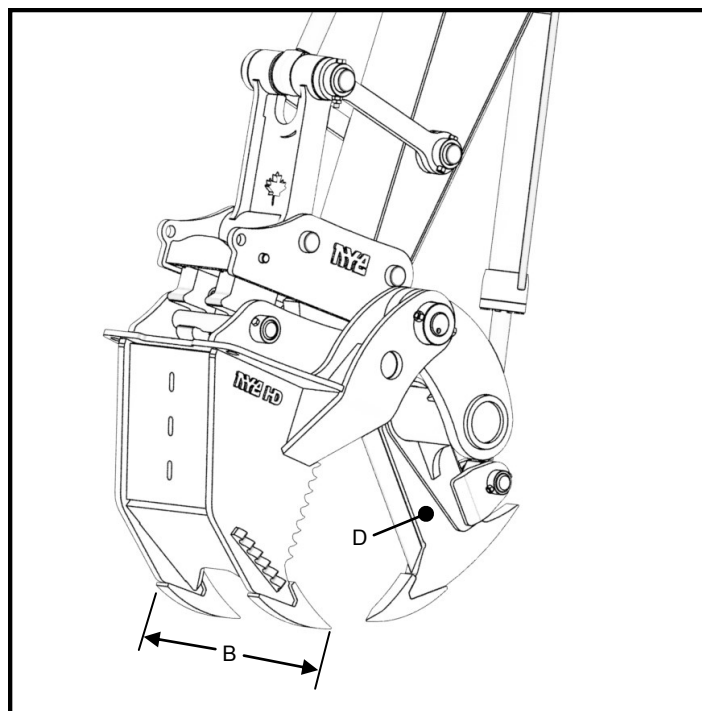
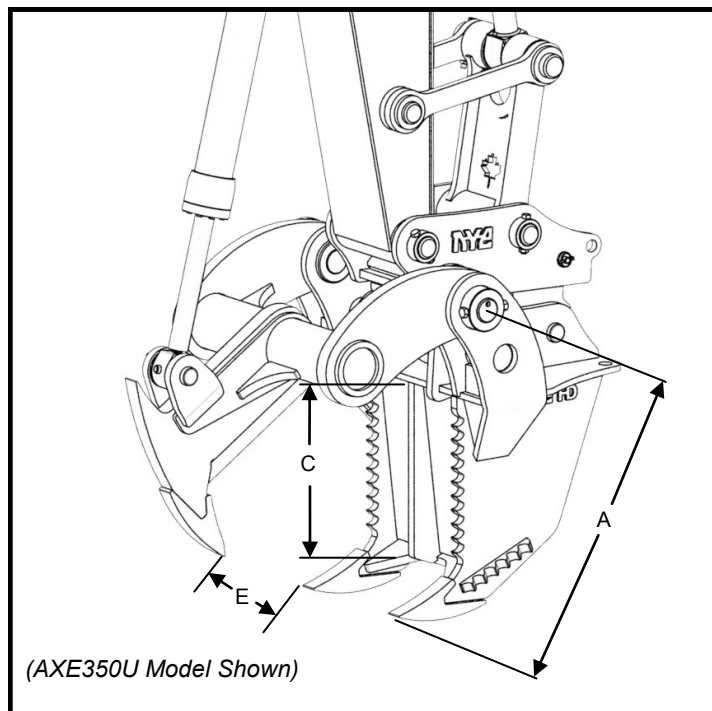

**Nye Manufacturing Ltd.**  
3585 Mavis Rd.  
Mississauga, ON L5C 1T7  
Canada  
+1 905 897 2311  
sales@nye.ca nye.ca

**National Attachments, Inc.**  
29 Olde Canal Way  
Gorham, ME 04038  
(800) 839 9981  
sales@nationalattachments.com



Scan for videos →  
**YouTube**

